

# Current Transducer LA 305-S

For the electronic measurement of currents: DC, AC, pulsed..., with galvanic isolation between the primary circuit (high power) and the secondary circuit (electronic circuit).

**$I_{PN} = 300 \text{ A}$**

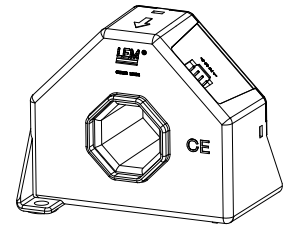

## Electrical data

$I_{PN}$	Primary nominal current rms	300	A				
$I_{PM}$	Primary current, measuring range	0 .. $\pm 500$	A				
$R_M$	Measuring resistance	$T_A = 70^\circ\text{C}$		$T_A = 85^\circ\text{C}$			
			$R_{M \min}$	$R_{M \max}$	$R_{M \min}$	$R_{M \max}$	
		with $\pm 12 \text{ V}$	@ $\pm 300 \text{ A}_{\max}$	0	52	0	50 $\Omega$
			@ $\pm 500 \text{ A}_{\max}$	0	17	0	15 $\Omega$
	with $\pm 15 \text{ V}$	@ $\pm 300 \text{ A}_{\max}$	0	75	5	73 $\Omega$	
		@ $\pm 500 \text{ A}_{\max}$	0	31	5	29 $\Omega$	
$I_{SN}$	Secondary nominal current rms	120	mA				
$K_N$	Conversion ratio	1 : 2500					
$V_C$	Supply voltage ( $\pm 5 \%$ )	$\pm 12 \dots 15$	V				
$I_C$	Current consumption	20 ( $\pm 15 \text{ V}$ ) + $I_S$	mA				

## Accuracy - Dynamic performance data

$X_G$	Overall accuracy @ $I_{PN}$ , $T_A = 25^\circ\text{C}$	$\pm 0.8$	%
$\epsilon_L$	Linearity error	$< 0.1$	%
$I_O$	Offset current @ $I_p = 0$ , $T_A = 25^\circ\text{C}$	Typ	$\pm 0.20$ mA
		Max	$\pm 0.20$ mA
$I_{OM}$	Magnetic offset current <sup>1)</sup> @ $I_p = 0$ and specified $R_M$ , after an overload of $3 \times I_{PN}$		$\pm 0.40$ mA
$I_{OT}$	Temperature variation of $I_O$ - $10^\circ\text{C} \dots +85^\circ\text{C}$	$\pm 0.12$	$\pm 0.30$ mA
$t_{ra}$	Reaction time @ 10 % of $I_{PN}$	$< 500$	ns
$t_r$	Response time <sup>2)</sup> @ 90 % of $I_{PN}$ step	$< 1$	$\mu\text{s}$
di/dt	di/dt accurately followed	$> 100$	A/ $\mu\text{s}$
BW	Frequency bandwidth (-3 dB)	DC .. 100	kHz

## General data

$T_A$	Ambient operating temperature	- 10 .. + 85	$^\circ\text{C}$
$T_S$	Ambient storage temperature	- 40 .. + 90	$^\circ\text{C}$
$R_S$	Secondary coil resistance	@ $T_A = 70^\circ\text{C}$	35 $\Omega$
		@ $T_A = 85^\circ\text{C}$	37 $\Omega$
$m$	Mass	200	g
	Standards	EN 50178: 1997	

**Notes:** <sup>1)</sup> The result of the coercive force (Hc) of the magnetic circuit

<sup>2)</sup> With a di/dt of 100 A/ $\mu\text{s}$ .

## Features

- Closed loop (compensated) current transducer using the Hall effect
- Isolated plastic case recognized according to UL 94-V0.

## Advantages

- Excellent accuracy
- Very good linearity
- Low temperature drift
- Optimized response time
- Wide frequency bandwidth
- No insertion losses
- High immunity to external interference
- Current overload capability.

## Applications

- AC variable speed drives and servo motor drives
- Static converters for DC motor drives
- Battery supplied applications
- Uninterruptible Power Supplies (UPS)
- Switched Mode Power Supplies (SMPS)
- Power supplies for welding applications.

## Application domain

- Industrial.

## Current Transducer LA 305-S

### Isolation characteristics

$V_d$	Rms voltage for AC isolation test, 50 Hz, 1 min	6	kV
$\hat{V}_w$	Impulse withstand voltage 1.2/50 $\mu$ s	20	kV
		Min	
<b>dCp</b>	Creepage distance	27	mm
<b>dCI</b>	Clearance distance	26.5	mm
<b>CTI</b>	Comparative Tracking Index (group IIIa)	225	

### Applications examples

According to EN 50178 and IEC 61010-1 standards and following conditions:

- Over voltage category OV 3
- Pollution degree PD2
- Non-uniform field

	EN 50178	IEC 61010-1
<b>dCp, dCI, <math>\hat{V}_w</math></b>	Rated insulation voltage	Nominal voltage
Single insulation	2500 V	2500 V
Reinforced insulation	1250 V	1250 V

According VDE 0160 (1994):  
 single insulation 3500 V  
 Reinforced insulation 1750 V

### Safety



This transducer must be used in electric/electronic equipment with respect to applicable standards and safety requirements in accordance with the manufacturer's operating instructions.



Caution, risk of electrical shock

When operating the transducer, certain parts of the module can carry hazardous voltage (eg. primary busbar, power supply).

Ignoring this warning can lead to injury and/or cause serious damage.

This transducer is a build-in device, whose conducting parts must be inaccessible after installation.

A protective housing or additional shield could be used.

Main supply must be able to be disconnected.

## Dimensions LA 305-S (in mm)

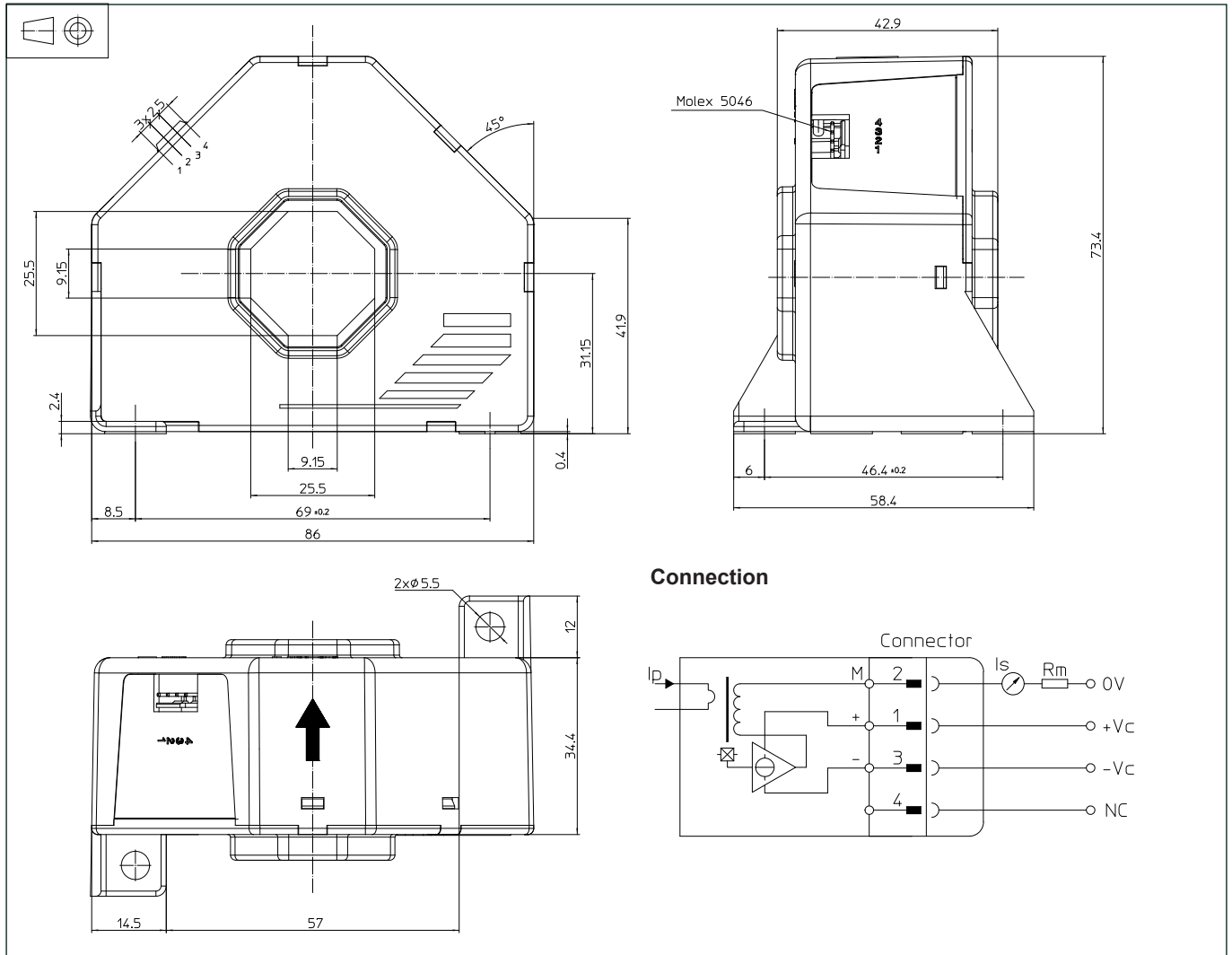

## Mechanical characteristics

- General tolerance  $\pm 0.5$  mm
- Transducer fastening  $2$  holes  $\varnothing 5.5$  mm  
2 M5 steel screws  
Recommended fastening torque 4 Nm
- Primary through-hole 25.5 x 25.5 mm
- Connection of secondary MOLEX 5046 4 pins  
tin plated

## Remarks

- $I_s$  is positive when  $I_p$  flows in the direction of the arrow.
- Temperature of the primary conductor should not exceed 100°C.
- Dynamic performances ( $di/dt$  and response time) are best with a single bar completely filling the primary hole.
- This is a standard model. For different versions (supply voltages, turns ratios, unidirectional measurements...), please contact us.