

NCH. Caps for clamping bolts

Rubber



MATERIAL

Black neoprene, hardness 85 Shore A.

APPLICATIONS

NCH. caps are designed to optimise use of clamping bolts.

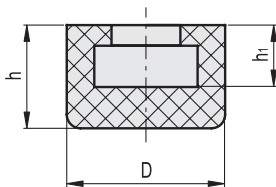

METRIC

Code	Description	D	h	h1	Δ	For plunger
GG.AU109	NCH.11-M4	11	6.5	4	1	SHH.M4
GG.AU110	NCH.12-M5	12	8	5.5	1	SHH.M5
GG.AU111	NCH.15-M6	15	10	6	2	SHH.M6
GG.AU112	NCH.19-M8	19	13	7.5	4	SHH.M8
GG.AU113	NCH.24-M10	24	16	9	7	SHH.M10
GG.AU114	NCH.26-M12	26	19	10.5	9	SHH.M12

NCN. Caps for clamping bolts

with threaded insert, steel and rubber



MATERIAL

Black neoprene, hardness 85 Shore A.

THREADED INSERT

Zinc-plated steel.

APPLICATIONS

NCN. caps with threaded insert are designed to optimise use of clamping bolts.

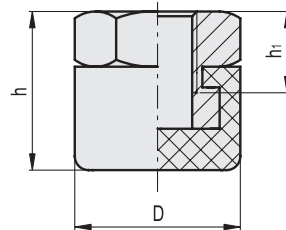

METRIC

Code	Description	D	h	h1	Δ	For plunger
GG.AU200	NCN.12-M5	12	11	8.5	4	M5
GG.AU201	NCN.15-M6	15	14	10	8	M6
GG.AU202	NCN.19-M8	19	18	12.3	17	M8
GG.AU203	NCN.24-M10	24	23.5	16.5	20	M10
GG.AU204	NCN.26-M12	26	26	17.5	25	M12

- 1
- 2
- 3
- 4
- 5
- 6
- 7
- 8
- 9
- 10
- 11
- 12
- 13
- 14
- 15
- 16
- 17
- 18

Toggle clamps