



- EP13 Package in SMD
- Operating temperature range: -40°C to +130°C
- Reflow Condition:  
Maximum reflow temperature is 250°C/-5°C  
time is 20~40 sec. (Refer to IPC/JEDECJ-STD-020 standard).

Electrical Specifications @25°C					
Inductance Lp @250KHz,0.1V (1 - 2)	Leakage Inductance Ls @100KHz,0.1V, (short 4+5, 6+7+9+10)	Isolation Voltage @ 1mA, 1 sec Pri & Aux to Sec	DCR 1 - 2	DCR 4 - 5	DCR 6,7 - 9,10
429.3uH ± 28%	0.5uH Max	1500 Vac	68mΩ Max	970mΩ Max	6.5mΩ Max

All specifications subject to change without notice.

**MECHANICAL**

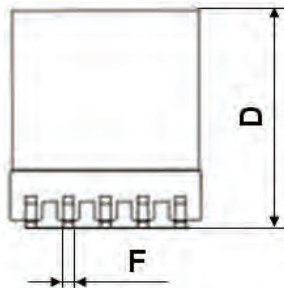
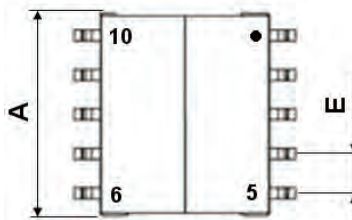
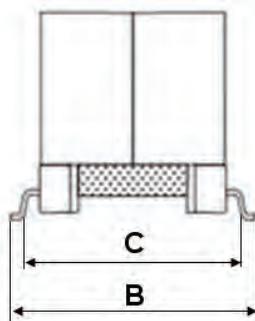

A	13.46 Max
B	17.65 Max
C	15.40 Ref
D	12.32 Max
E	2.50 ± 0.15
F	0.70 ± 0.1
Unit : mm	

**Marking**

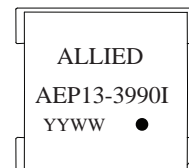

**SCHEMATICS**

