



- EP13 Package in SMD
- Operating temperature range: -40°C to +130°C
- Reflow Condition:
Maximum reflow temperature is 250°C/-5°C
time is 20~40 sec. (Refer to IPC/JEDECJ-STD-020 standard).

Electrical Specifications @25°C				
Inductance Lp @10KHz,0.1V (5 - 3)	Leakage Inductance Ls @100KHz,0.1V, (5 - 3) (short 6+10)	Turns Ratio @un-gapped Core (5 - 3) : (2-1)	Turns Ratio @un-gapped Core (5 - 3) : (6 - 10)	Turns Ratio @un-gapped Core (6 - 10) : (8 - 10)
37uH (±10%)	0.75uH Max	1.83:1 (±2%)	2:1 (±2%)	2.22 : 1 (±2%)

Electrical Specifications @25°C				
DCR (5 - 3)	DCR (2 - 1)	DCR (6 - 10)	Hi-Pot @ 1 sec, 1mA 5, 2 to 6	Hi-Pot @ 1 sec, 1mA 5 to 2
96mΩ Max	96mΩ Max	33mΩ Max.	1875 Vac	625 Vac

All specifications subject to change without notice.

MECHANICAL

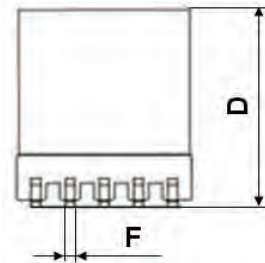
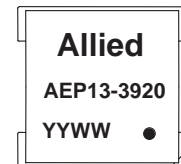
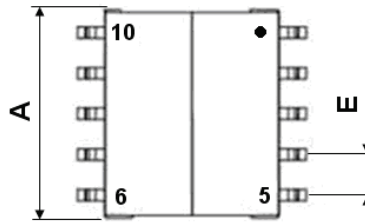
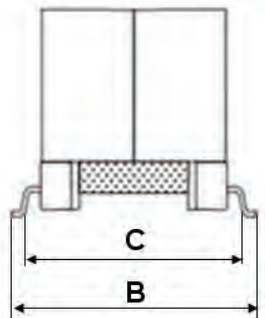

A	13.46 Max
B	17.65 Max
C	15.40 Ref
D	12.32 Max
E	2.50 ± 0.15
F	0.70 ± 0.1
Unit : mm	

SCHEMATICS

