

© 2016 MURRPLASTIK SYSTEMS, INC. THIS DOCUMENT IS THE SOLE AND EXCLUSIVE PROPERTY OF MURRPLASTIK SYSTEMS, INC. THE DOCUMENT AND ANY INFORMATION CONTAINED HEREIN MAY NOT BE COPIED, REPRODUCED OR USED IN ANY MANNER WITHOUT THE EXPRESS WRITTEN CONSENT OF MURRPLASTIK SYSTEMS, INC.

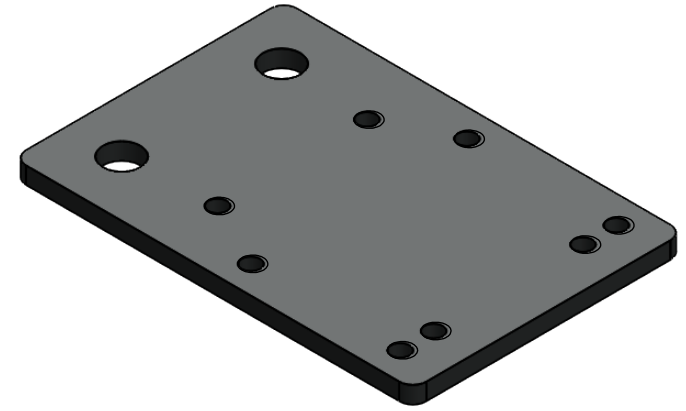

Required Hardware	
QTY	Description
2	M12 x 25 SHCS
2	M12 Flat Washer
2	M12 Split Washer

UNLESS OTHERWISE SPECIFIED
 DIMENSIONS ARE IN MM
 TOLERANCES ARE:
 DECIMALS ANGLES
 X. ± .5 ± 1°
 .X ± .25
 .XX ± .125

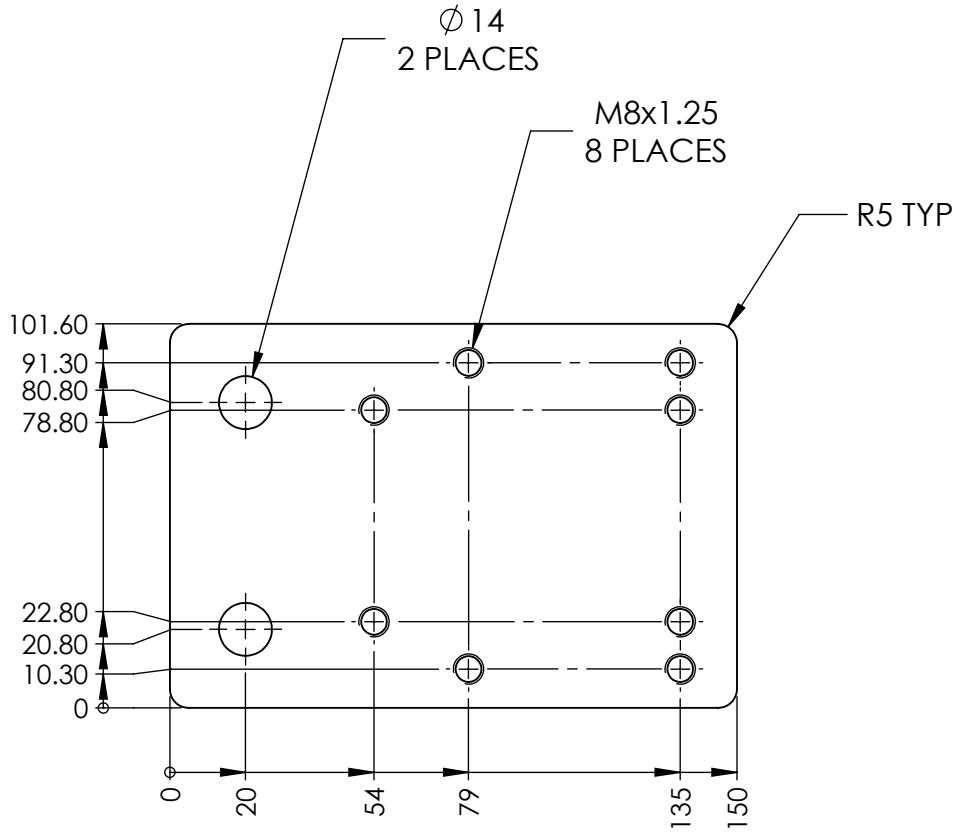
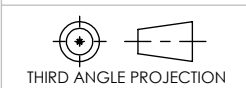

DO NOT SCALE DRAWING

MATERIAL:
 Steel

FINISH:
 Paint (Black)

SCALE 1:2

APPROVALS DATE

DRAWN HH 9/28/2017

CHECKED RH 9/28/2017



Murrplastik Systems, Inc.
 1175 US Highway 50
 Milford, OH 45150
 513-201-3069

TITLE
 Post Clamp Mount Plate

SIZE DWG. NO. 83800014

REV 1

ECN	REV.	DESCRIPTION	DATE	CHG. BY