

Middle Power PCB Relay for Automotive and DC 12 V/24 V Applications

G8G Relay

Middle Load Relay for Motor/Heater Control Applications

- Can replace Micro ISO Plug-in type relay
- Small size & High heat resistance enable for usage in engine room
- Can support 40 A Fuse
- PIP reflow compliant
- Temperature range -40°C to +125°C
- DC24V Model for the applications of commercial vehicle also available



Model Number Legend

G8G-□□□□
1 2 3 4

1. Number of Contact Poles/Structure

- 1A: SPST (1 Form A)
- 1 : SPDT (1 Form C)

2. Protective structure

- Blank or 4: Plastic sealed (RT III IEC61810)
- 7 : Flux tight (Open vent hole) (RT II IEC61810)

3. Characteristics

- Blank: Standard
- S : Low operating voltage

4. Special function

- R: Pin in paste compliant type
- V: DC24V Model

Application Examples

- DC motor/resistive application control
- Automotive DC applications (Smart Junction Box, Blower fan, PTC heater, Seat heater, Power for accessory, A/C magnet clutch, Motor control for Commercial vehicle, etc.)

Ordering Information

Classification	Contact form	Protective structure	Rated coil voltage (V)	Model	Minimum Packing unit (Tube packing)
Standard	SPST 1 Form A	Flux tight (open vent hole) (RT II IEC61810)	DC12	G8G-1A7R DC12	1920 pcs. / box (64 pcs. × 30 tubes)
	SPDT 1 Form C			G8G-17R DC12	
Low operation voltage	SPST 1 Form A			G8G-1A7SR DC12	
	SPDT 1 Form C			G8G-17SR DC12	
DC24V Model	SPDT 1 Form C	Plastic sealed (RT III IEC61810)	DC24	G8G-1SV DC24	

Note. Above models are not certificated for the safety standards of UL or CSA, etc.

Ratings

Coil

Rated voltage (V)	Rated current (mA)	Coil resistance (Ω)	Must-operate voltage (V)	Must-release voltage (V)	Permissible voltage Range (V)	Rated Power consumption (mW)	Model
DC12	40.0	300	6.5 Max.	0.5 Min.	10 to 16	480	G8G-1A7R DC12
							G8G-17R DC12
	53.3	225	5.5 Max.			640	G8G-1A7SR DC12
						G8G-17SR DC12	
DC24	106.7	225	14.4 Max.	1 Min.	18.2 to 32	2560	G8G-1SV DC24

Note 1. The rated current and coil resistance are measured at a coil temperature of 20°C with a tolerance of ±10%.

Note 2. The operating characteristics are measured at a coil temperature of 20°C.

●Contacts

Item	Classification Model	Standard	Low operating voltage	DC24V Model
		G8G-1A7R DC12 G8G-17R DC12	G8G-1A7SR DC12 G8G-17SR DC12	G8G-1SV DC24
Contact material		Silver-alloy		
	at 85°C	-	-	5 A
	at 110°C	20 A	15 A	-
	at 125°C	15 A	10 A	-
Max. switching current		84 A Inrush / 35 A Break (N.O.)		20 A Inrush / 14 A Break (N.O.)
Max. carrying current *1	20 A fuse 200%	-	-	40 A at DC28V for 10 mins
	30 A slow fuse 135%	40.5 A at DC14V for 60 mins		-
	40 A blade fuse 135%	54 A at DC14V for 2 mins		-
Min. switching current		DC12V, 1 A		

*1. The value is applicable at an ambient temperature 20°C. This does not guarantee repeated condition. Also depends on the connecting conditions. Please contact our sales representative if you have specific conditions.

■Characteristics

Item		G8G-1A7R DC12 G8G-17R DC12	G8G-1A7SR DC12 G8G-17SR DC12	G8G-1SV DC24
Contact resistance (See *1.)		Typ.3.0 mΩ max.20 mΩ		
Operate time		10 ms max. (DC12V not including bounce time)		10 ms max. (DC24V not including bounce time)
Release time		5 ms max. (DC12V not including bounce time)		5 ms max. (DC24V not including bounce time)
Insulation resistance (See *2.)	Between coil and contacts	100 MΩ min.		
	Between contacts of the same polarity	100 MΩ min.		
Dielectric strength	Between coil and contacts	AC500V 1 min		
	Between contacts of the same polarity	AC500V 1 min		
Vibration resistance	Destruction	33 Hz, 45 m/s ²		
	Malfunction	10 to 200 Hz, 45 m/s ² (detection time: 10 μs)		
Shock resistance	Destruction	1,000 m/s ² (pulse duration: 6 ms)		
	Malfunction	100 m/s ² (pulse duration: 11 ms detection time: 10 μs)		
Mechanical endurance (See *3.)		1,000,000 ops. min.		
Electrical endurance (See *4.)	Resistive Load	DC14V, N.O. 35 A / N.C. 15 A, 1.0 s ON/9.0 s OFF, 100,000 ops.		DC28V, N.O. 14 A / N.C. 5 A, 1.0 s ON/1.0 s OFF, 100,000 ops.
	Lamp Load	DC14V, 84 A Inrush / 12 A Break, 1.0 s ON/9.0 s OFF, 100,000 ops.		DC28V, 20 A Inrush / 2 A Steady, 1.0 s ON/1.2 s OFF, 100,000 ops.
	Motor Load	DC14V, 32 A, 0.25 mH, Motor locked, 0.25 s ON/9.75 s OFF, 100,000 ops.		DC28V, 12 A, 3 mH, Motor locked, 0.25 s ON/4.75 s OFF, 100,000 ops.
Ambient operating temperature		-40 to 125°C (without freezing or condensation)		-40 to 85°C (without freezing or condensation)
Ambient operating humidity		35% to 85% RH		
Weight		Approx. 5.2 g		Approx. 6.0 g

Note. The above values are initial values at an ambient temperature of +20°C unless otherwise specified.

*1. The contact resistance was measured with 1 A at DC5V using the voltage drop method.

*2. The insulation resistance was measured with a DC500V megohmmeter.

*3. The mechanical endurance was measured at a switching frequency of 18,000 operations/hr.

*4. Please connect N.O. terminal to the +BATT side on Electrical use and connect surge suppression element in parallel with between coil based on recommended circuit.

Recommended circuit: (a), (b), (c)

Not-recommended circuit: (d)

Note:

OMRON recommends coil driver circuit (b) and (c) for coil surge suppression. However the circuit (d) is not recommended because it may negatively affect the durability performance.

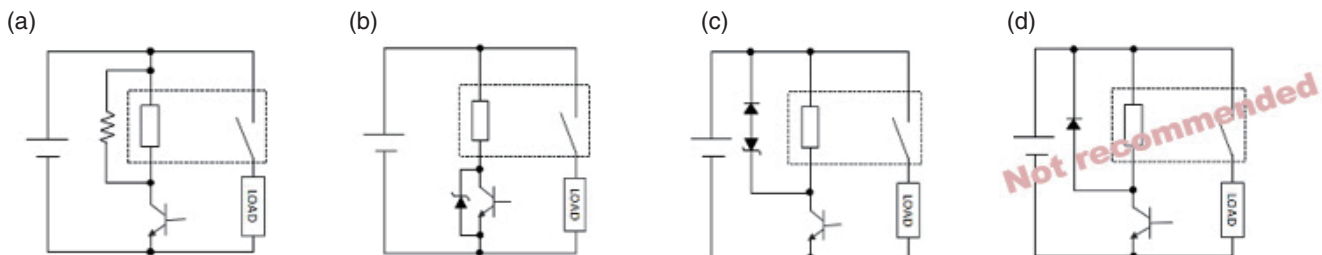

Reference Technical Data

Actual Electrical performance (reference)

Model	Application	Load voltage	Inrush	Steady state	Switching off	Inductance	Ambient temperature	Switching frequency		Required Cycles
		(V)	(A)	(A)	(A)			(mH)	(°C)	On (s)
G8G-17R DC12	N.O. Inductive	14	60	12		0.5	-40°C to +125°C	3.0	5.0	250,000
G8G-17R DC12	Wiper On Off	14	32.4	4.33	22	1	-40°C to +105°C	2.0	2.0	700,000
G8G-1A7R DC12	Blower Fan	14	46.6	22		0.5	-40°C to +85°C	3.0	5.0	150,000
G8G-1A7R DC12	A/C clutch	14	3.8	3.8		14	-40°C to +110°C	1.0	1.0	2,000,000
G8G-1SV DC24	Motor lock	28			12	3	25	0.25	4.75	100,000
G8G-1SV DC24	Motor free	28	15	2.5		0.25	25	1.0	4.0	100,000
G8G-1SV DC24	N.O. Resistive	28		14			25	1.0	1.0	100,000
G8G-1SV DC24	N.C. Resistive	28		5			25	1.0	1.0	100,000
G8G-1SV DC24	N.O. Lamp	28	20	2			25	1.0	1.2	100,000

Operating Voltage and Release Voltage Distributions (Number of Relays × Percentage of Rated Voltage)

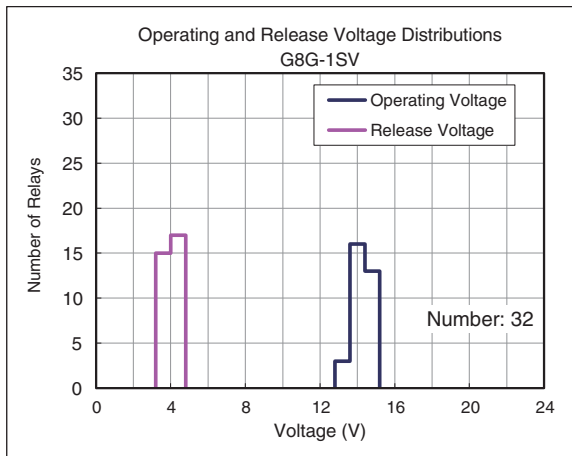
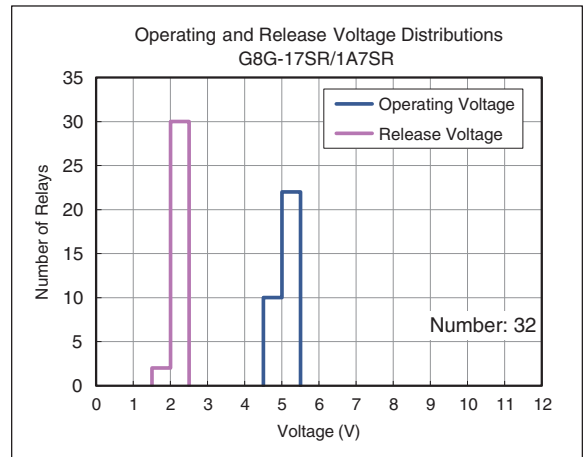
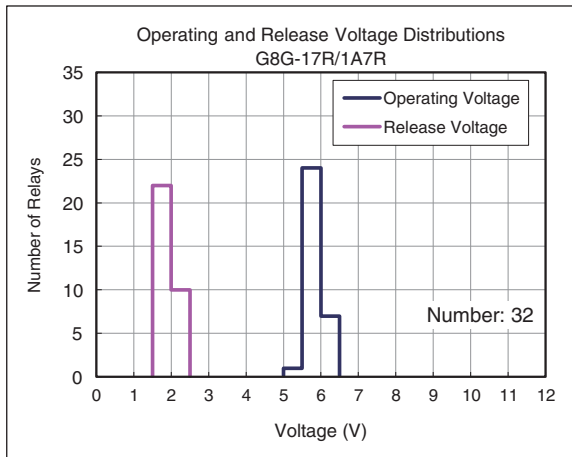

●Time Characteristic Distributions
(Number of Contacts × Time (ms))

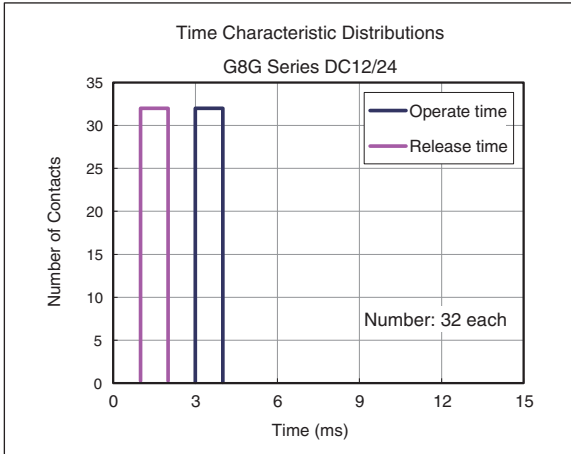

●Operating voltage vs ambient temperature (Cold start)

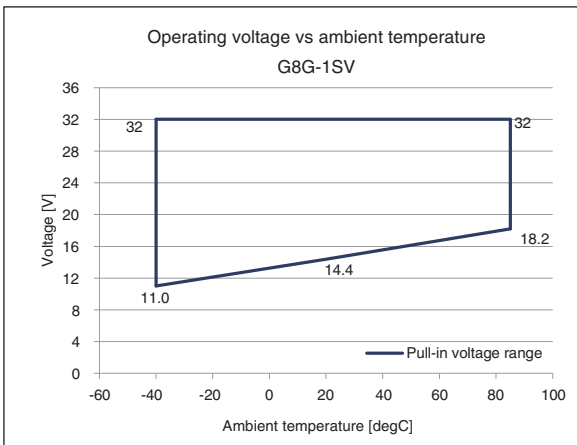
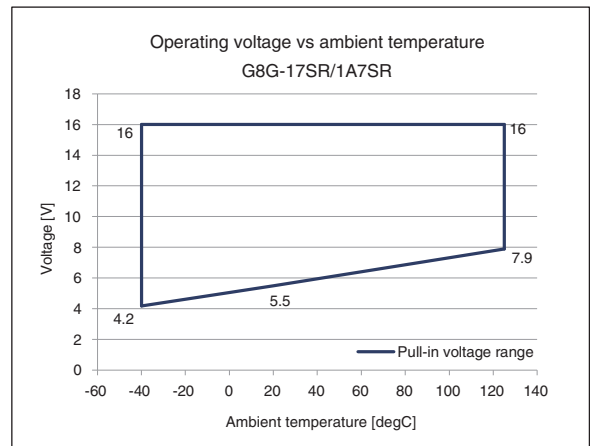
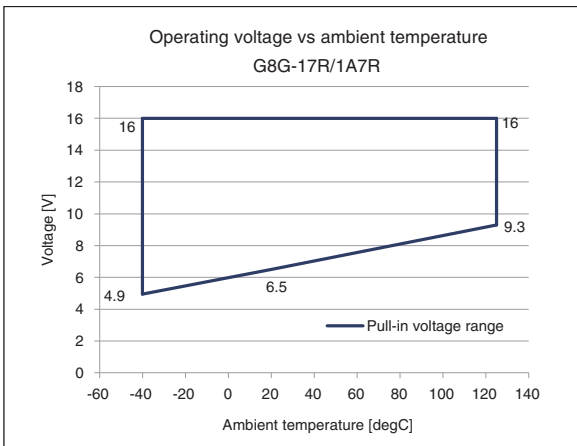

●Coil temperature rise [degC] at 20°C

(For using under a higher ambient temperature, please select the proper current carrying condition to avoid a possible excessive temperature rising.)

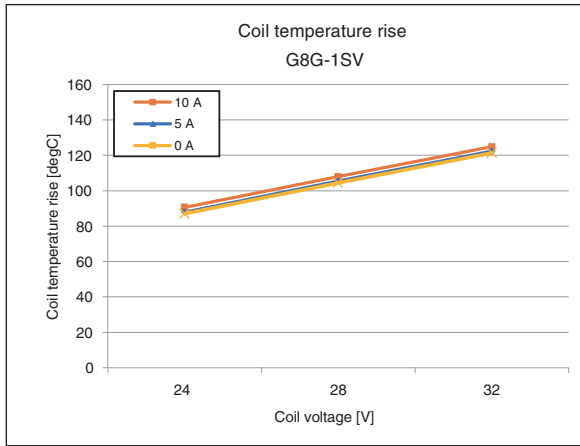
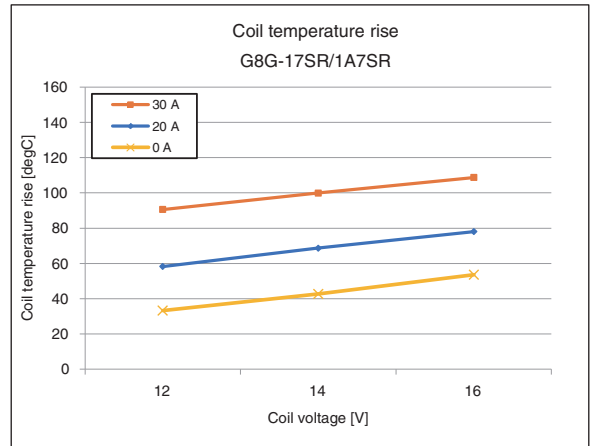
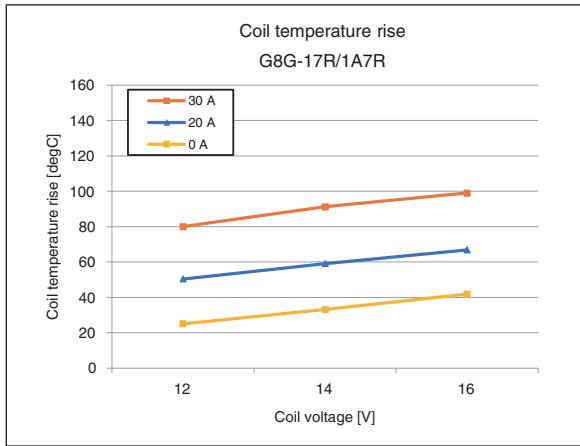

●Derating curve

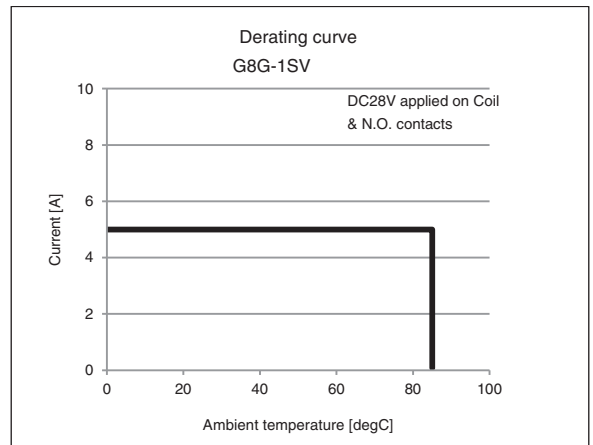
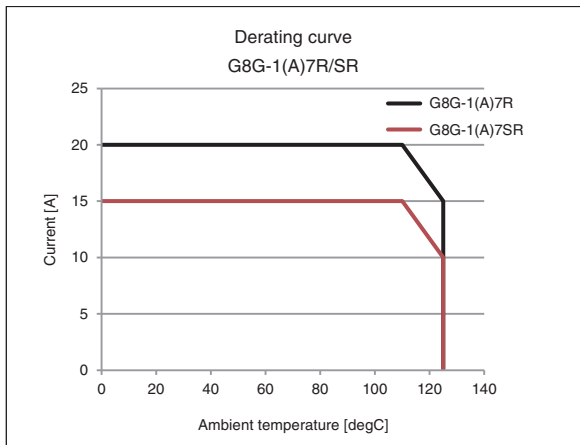

■ Dimensions

CAD Data Please visit our website, which is noted on the last page.

(Unit: mm)

G8G-17R/17SR

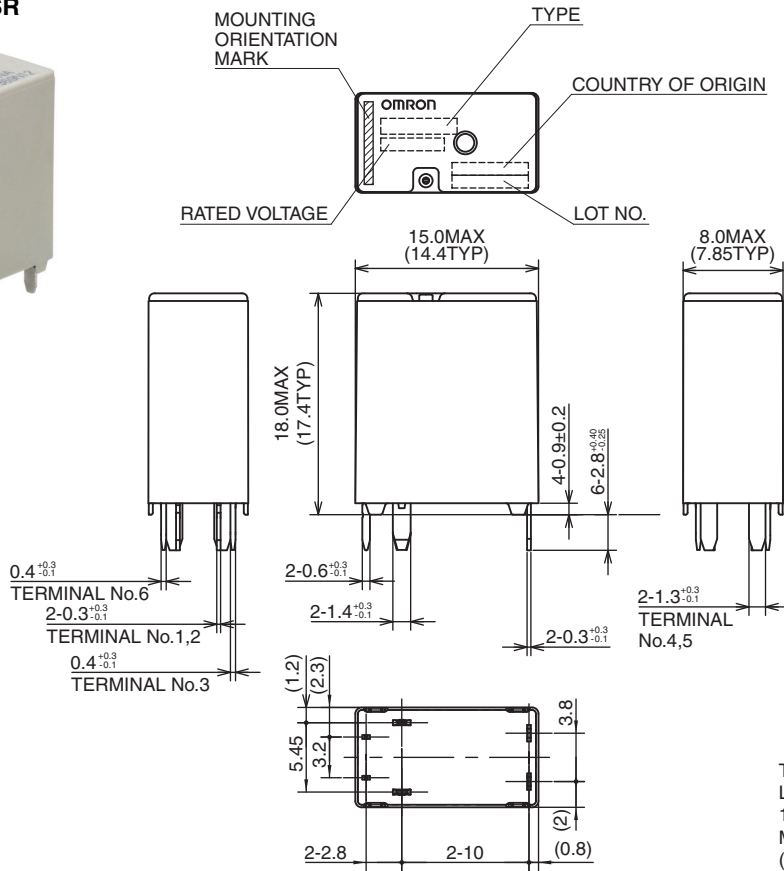

FOR REFERENCE : PCB MOUNTING HOLES (BOTTOM VIEW)

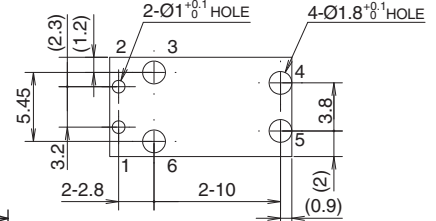

*Please study & choose other appropriate hole diameters if confirmed the diameter values recommended above don't work with the soldering process.

TERMINAL ARRANGEMENT/ INTERNAL CONNECTIONS (BOTTOM VIEW)

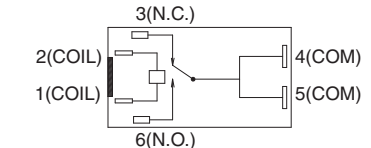

NOTE: *TERMINAL 6 CONNECTS TO +BATT.

TOLERANCE UNLESS OTHERWISE SPECIFIED

Less than 1 mm :±0.1 mm

1 to 3 mm :±0.2 mm

More than 3 mm :±0.3 mm

() is reference dimension

CAD Data

G8G-1A7R/1A7SR

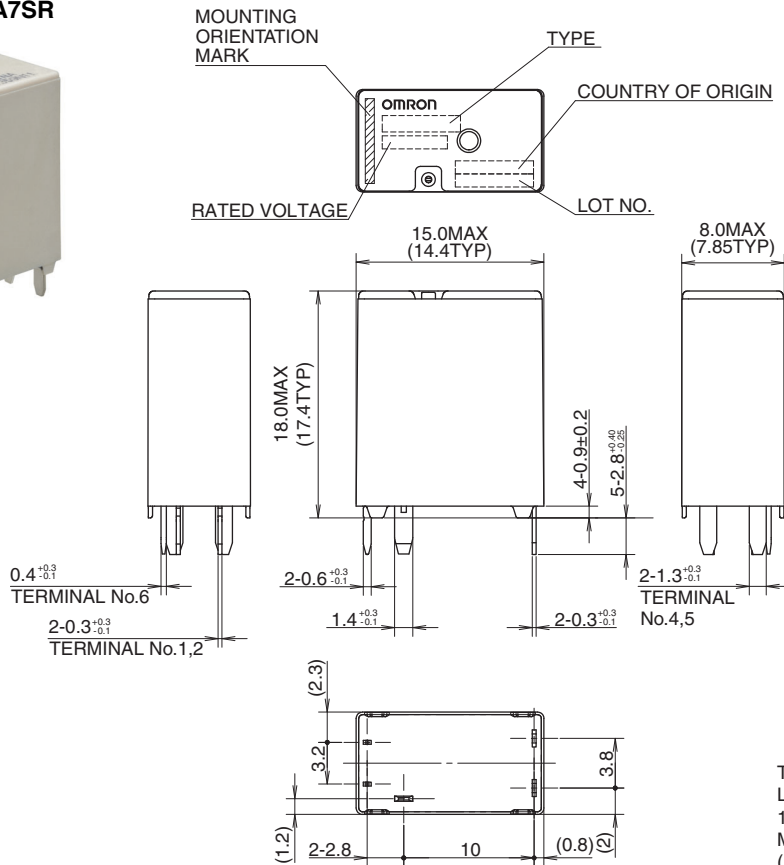

FOR REFERENCE : PCB MOUNTING HOLES (BOTTOM VIEW)

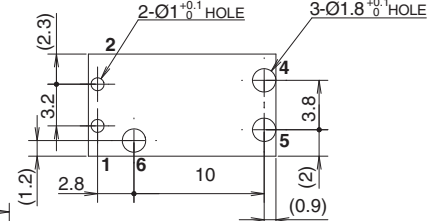

*Please study & choose other appropriate hole diameters if confirmed the diameter values recommended above don't work with the soldering process.

TERMINAL ARRANGEMENT/ INTERNAL CONNECTIONS (BOTTOM VIEW)

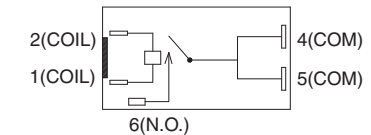

NOTE: *TERMINAL 6 CONNECTS TO +BATT.

TOLERANCE UNLESS OTHERWISE SPECIFIED

Less than 1mm :±0.1mm

1 to 3mm :±0.2mm

More than 3mm :±0.3mm

() is a reference dimension

CAD Data

■ Dimensions

CAD Data Please visit our website, which is noted on the last page.

(Unit: mm)

G8G-1SV

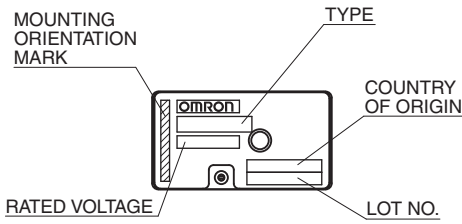

FOR REFERENCE : PCB MOUNTING HOLES (BOTTOM VIEW)

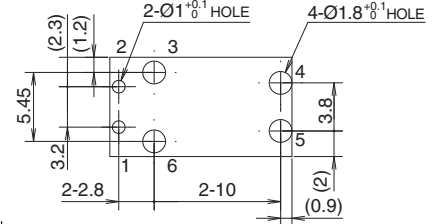

*Please study & choose other appropriate hole diameters if confirmed the diameter values recommended above don't work with the soldering process.

TERMINAL ARRANGEMENT/ INTERNAL CONNECTIONS (BOTTOM VIEW)

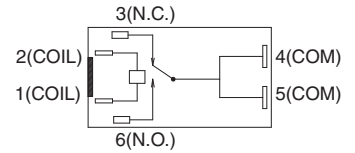

NOTE: *TERMINAL 6 CONNECTS TO +BATT.

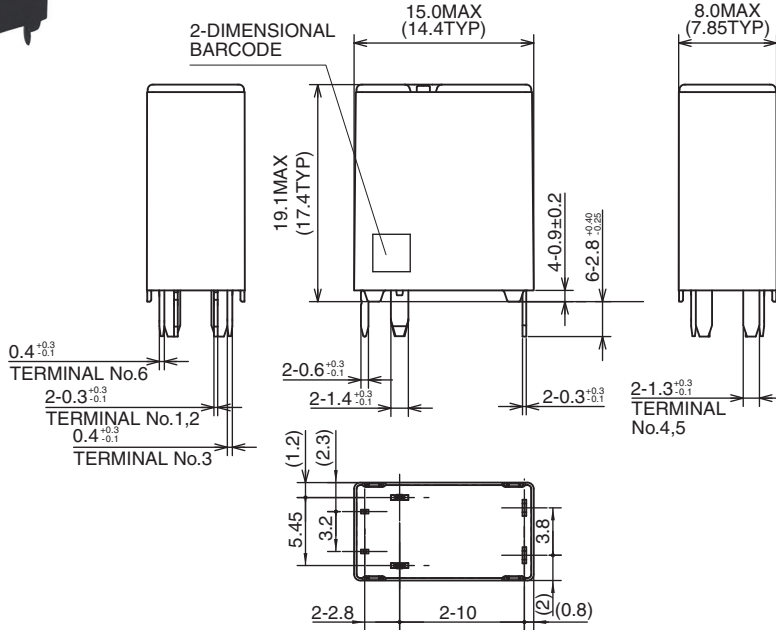

TOLERANCE UNLESS OTHERWISE SPECIFIED
 Less than 1 mm :±0.1 mm
 1 to 3 mm :±0.2 mm
 More than 3 mm :±0.3 mm
 () is reference dimension

CAD Data

■Precautions

- Please refer to “Safety Precautions for All Automotive Relays” for correct use.

Please check each region's Terms & Conditions by region website.

OMRON Corporation

Device & Module Solutions Company

Regional Contact

Americas

<https://components.omron.com/us>

Asia-Pacific

<https://components.omron.com/ap>

Korea

<https://components.omron.com/kr>

Europe

<https://components.omron.com/eu>

China

<https://components.omron.com.cn>

Japan

<https://components.omron.com/jp>